

SBC 0001

STOCKTON BOROUGH COUNCIL  
PLANNING  
11 AUG 2010  
DATE RECEIVED

10/2110

NZ 4516 SW  
NZ 4416 SE

H.M. LAND REGISTRY		TITLE NUMBER	
		CE9775	
ORDNANCE SURVEY PLAN REFERENCE	COUNTY	SHEET	NATIONAL GRID
	YORKSHIRE		NZ 4515
	ADMINISTRATIVE AREA STOCKTON-ON-TEES		SECTION
			C
Scale: 1/1250	© Crown copyright 1973.		

~~TEESSIDE COUNTY BOROUGH~~

COUNTY OF CLEVELAND  
STOCKTON-ON-TEES DISTRICT

10/2110

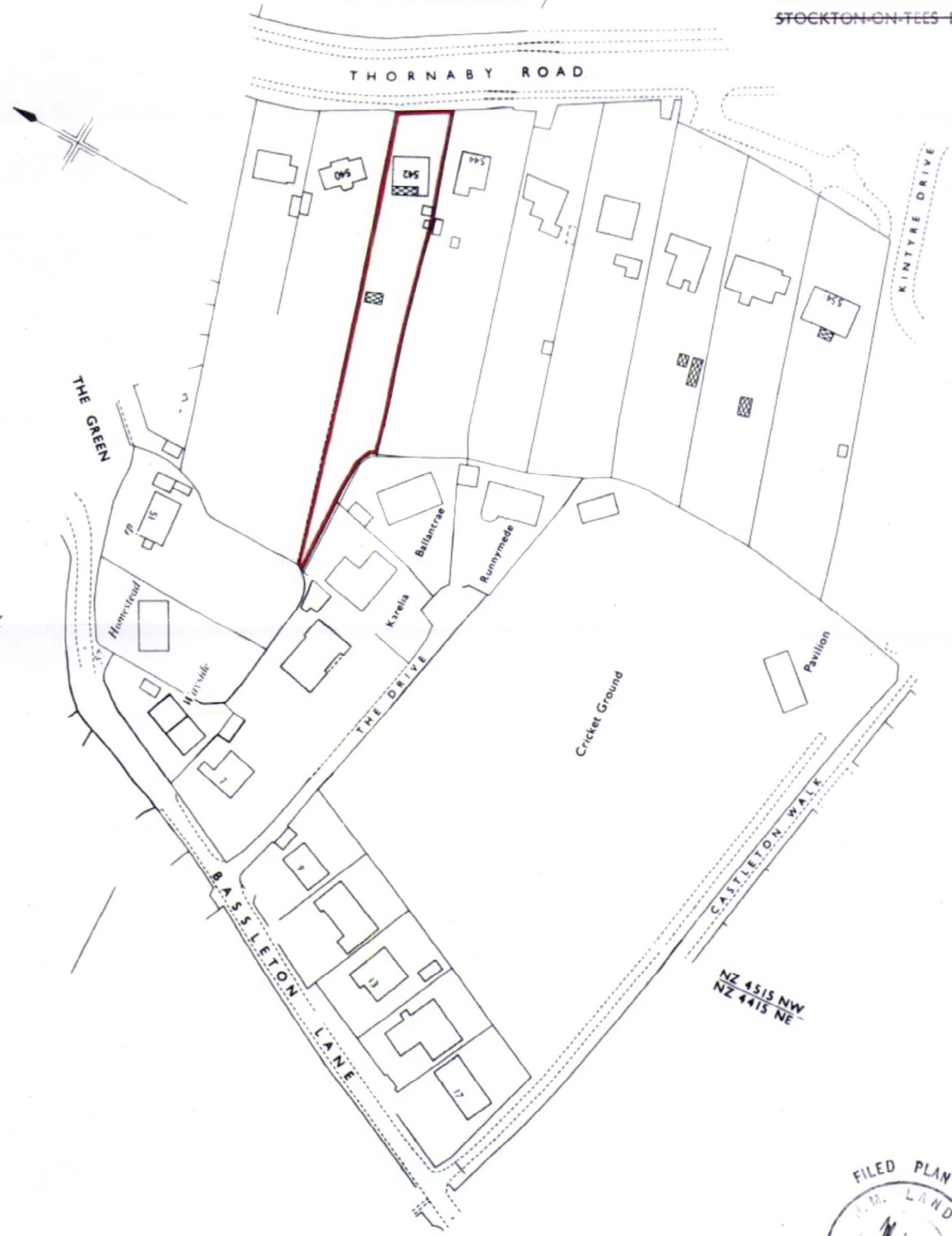

NZ 4515 NW  
NZ 4415 NE



This title is dealt with by Land Registry, Durham (Southfield) Office.  
 This is a copy of the title plan on 12 DEC 2006 at 19:16:48. This copy does not take account of any application made after that time even if still pending in the Land Registry when this copy was issued.  
 This copy is not an 'Official Copy' of the title plan. An official copy of the title plan is admissible in evidence in a court to the same extent as the original. A person is entitled to be indemnified by the registrar if he suffers loss by reason of a mistake in an official copy. If you want to obtain an official copy, the Land Registry web site explains how to do this.  
 The Land Registry endeavours to maintain high quality and scale accuracy of title plan images. The quality and accuracy of any print will depend on your printer, your computer and its print settings. When printed, the copy plan will not necessarily be to the scale shown on the original.  
 © Crown Copyright. Produced by HMLR. Further reproduction in whole or in part is prohibited without the prior written permission of Ordnance Survey. Licence Number GD272728.